

精确螺旋给料机

Precision Screw Feeder

产品目录

Product catalog

版本: V23.02

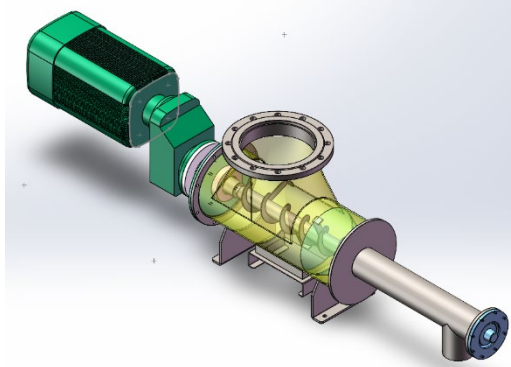

FD系列

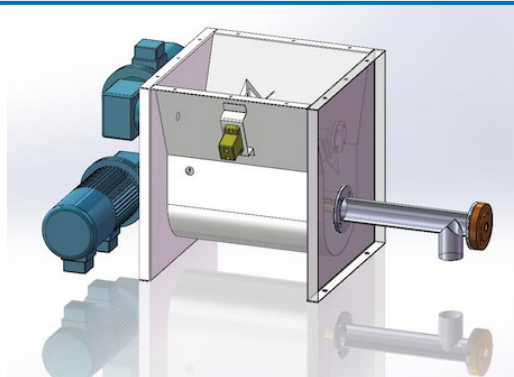

NTD系列



SDL系列

精确螺旋给料机 Precision Screw Feeder

FD系列 FD Series

产品描述Description :

FD系列螺旋给料机是一个连续的螺旋给料投加设备，适用于输送各种固体颗粒料、片剂料及粉末料，通过变频器的控制，可得到与频率成线性正比的投加量。主要应用于输送量大的场合，通常与料仓或称重料斗配套使用。

FD series screw feeder is a continuous screw conveyor dosing equipment, applicable to transport all kinds of solid particles, tablets and powder material, through the control of frequency converter, and the frequency can be obtained into linear proportional dosing quantity. Mainly used in occasions, but which is equipped with bunker or weighing hopper.

根据不同的粉料特性与应用需要，为达到最佳的工况效果，厂家将为用户配置不同的单元组件，包括电机减速机形式、螺旋叶片和搅拌犁刀形式，并支持非标尺寸的定制。

Depending on the powder properties and application needs, to achieve the best condition effect, manufacturers will be for the user to configure different cell components, including motor reducer, helical blade and stirring colter forms, and support custom non-standard sizes.



NTD系列 NTD Series

型号与技术参数 Model and technical parameter

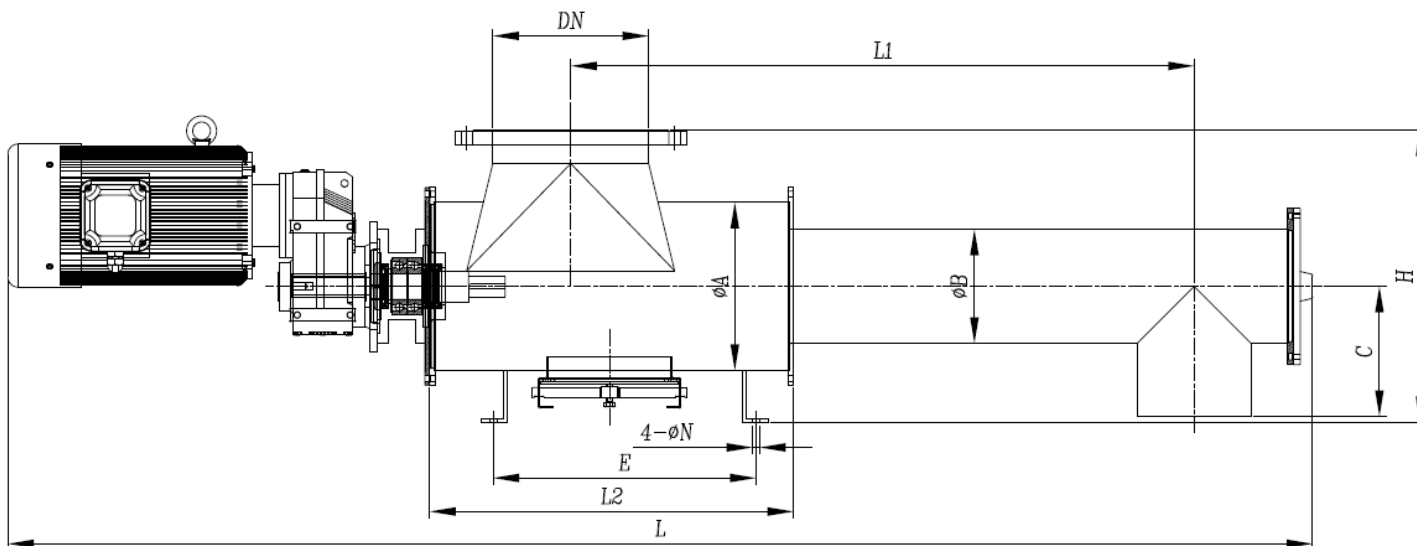

型号	给料量Max	电机功率	外型尺寸 (mm)								
	m ³ /h	kW	ΦA	ΦB	C	DN	E	H	L1	L	ΦN
FD-114	1.5	0.75	273	114	207	250	506	536	900	~2160	4-Φ14
FD-168	5	1.1	273	168	234	250	506	536	1000	~2285	4-Φ14
FD-219	11	1.5	323	219	250	300	506	562	1200	~2610	4-Φ14

注:

- 1、最大给料量为标准物料测试，不同物料因堆密度不同各有差异；
- 2、设备外型尺寸及结构可根据用户需求，支持非标定制；

精确螺旋给料机 Precision Screw Feeder

NTD系列 NTD Series

产品描述Description :

NTD系列螺旋给料机是一个精确的粉料定量添加设备，专门用于输送固体粉末或颗粒物料处理的容积测量式连续喂料，机身是由不锈钢或耐腐蚀的PP材质构成，包括几乎所有的粉料助剂。成功应用于水处理工业、食品、建筑、塑料和造纸等行业的各种技术工艺过程。

NTD series screw feeder is an accurate quantitative add powder equipment, specially for the conveying of solid powder or granular materials handling volume measurement type continuous feeding, the fuselage is made up of stainless steel or corrosion resistant PP material, including almost all of the powder additives. Successfully applied in water treatment industry, food, construction, plastic and paper industries such as all kinds of technical process.

设备可选配辅助下料振动器、料位传感器、一体加工的有轴或无轴螺旋、不同容积的料斗、真空上料机以及称重功能，常用于给料量小、精度要求高的的独立投加场合。

Optional auxiliary blanking vibrator, material level sensor, integrated processing of shaft or no shaft screw and different volume of hopper, vacuum feeding machine and weighing function, are often used to quantificationally small, high accuracy requirement of the independent additive.

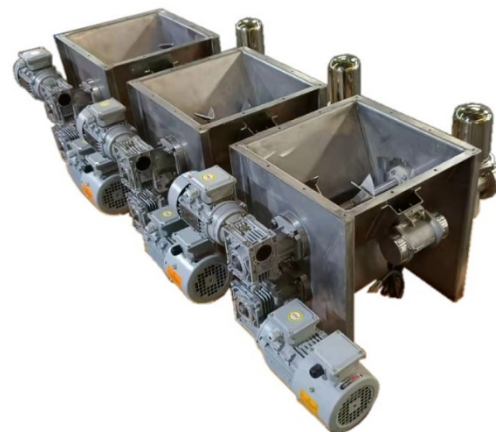

NTD系列 NTD Series

型号与技术参数 Model and technical parameter

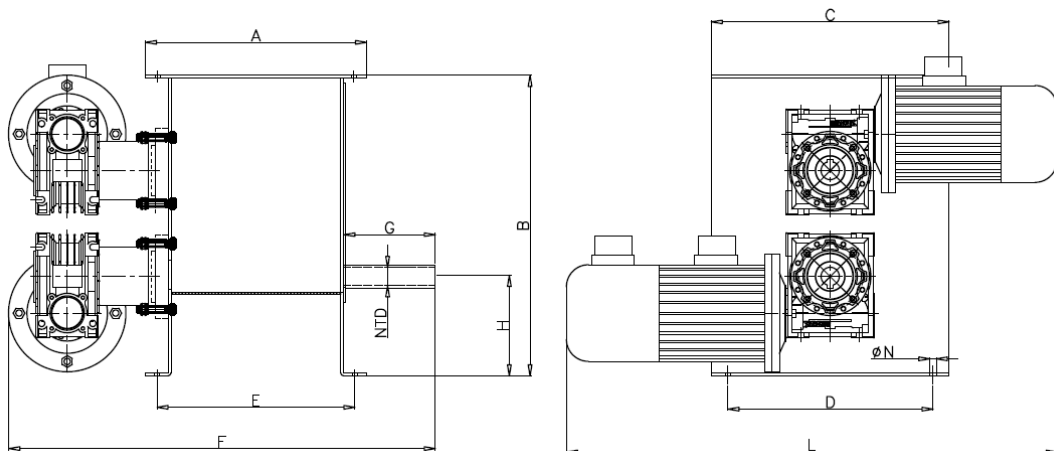

选配附件:

- 1、下料振动器
- 2、独立搅拌电机
- 3、料位传感器
- 4、料管加热器
- 5、料斗容积
- 6、其他特殊要求

型号	给料量	电机功率	外型尺寸 (mm)									
	kg/h	kW	A	B	C	D	E	F	G	H	L	ΦN
NTD20-12	1~12	0.37	302	410	325	280	270	583	116	137	670	4-Φ9
NTD24-12	3~30	0.37	302	410	325	280	270	583	116	137	670	4-Φ9
NTD40-20	20~190	0.37	302	410	325	280	270	583	116	137	670	4-Φ9
NTD60-22	70~690	0.55	414	420	360	328	385	927	268	90	670	4-Φ9

注：给料量为标准物料测试数据，不同物料因堆积密度等特性不同略有差异。

精确螺旋给料机 Precision Screw Feeder

SDL系列 SDL Series

产品描述Description :

SDL系列双螺杆失重式喂料机适用于0.5-2500L/h的计量添加，对流动性较差的粉料，添加剂，助剂，玻维，片状料等都能得到精确的配比，给料精度 $\leq \pm 0.5\%$ 。配备水平搅拌改善物料向螺杆推进部的流动，使喂料更加精确。改进设计的螺杆安装拆卸方便，螺杆根部不会堆积物料。

SDL series double spiral weightlessness feeder is suitable for 0.5~2500 l/h measurement to add, the less liquid powder, additives, additives, bo d, sheet material and so on all can get accurate ratio, the feeding accuracy $\pm 0.5\%$ or less. Equipped with mixing improves the flow of material to the screw propulsion, feeding more accurate. Improving design of screw to install and disassemble because it is the root of the screw won't pile up materials.

根据不同的物料可选择相对应的加料螺杆，驱动电机可选变频电机或伺服电机。料斗规格可选配不同的容积，对流动性差，容易架桥的物料还可以配备垂直搅拌。

According to the different material can choose corresponding feed screw, optional drive motor frequency conversion motor or servo motor. Hopper is optional specifications for different volume, the liquidity is poor, easy to bridge material can also be equipped with vertical mixing.



SDL系列 SDL Series

型号与技术参数 Model and technical parameter

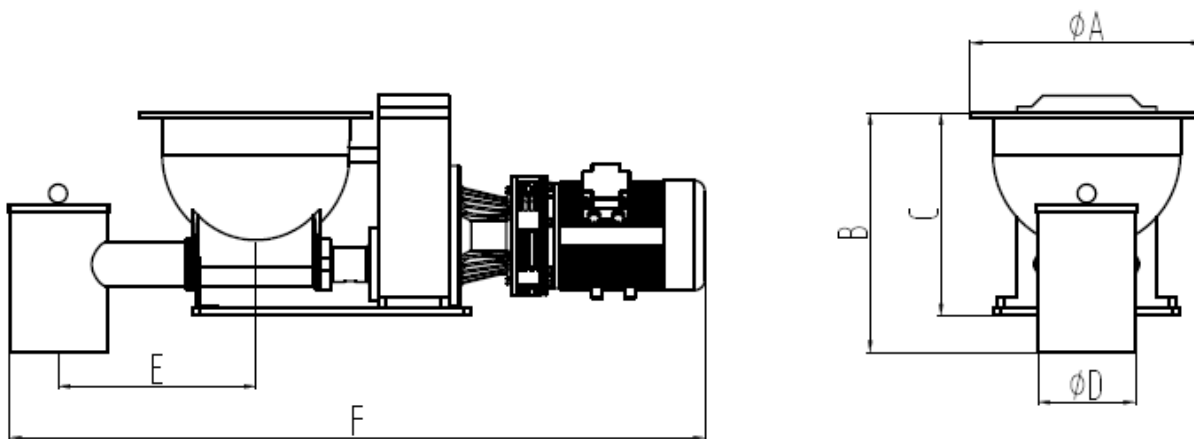

型 号	喂料量	电机功率	标准料斗	外型尺寸 (mm)					
	kg/h	kW	L	ΦA	B	C	ΦD	E	F
SDL-T20	0.5~10	0.37	10	183	170	170	76	138	700
SDL-T28	2~200	0.55	40	285	256	231	102	255	900
SDL-T38	40~600	1.5	50	318	326	276	133	270	1000
SDL-T46	300~1500	1.5	120	330	303	305	159	318	1150
SDL-T64	500~2500	2.2	180	390	328	322	219	431	1385

注：喂料量是在物料密度0.5kg/L的情况下测得。